

Product Name: Touch Dimmer Switch

Product description: This product is a unique design for Class III insulation appliance based on human touch applications.

Function description: When the human touch the touch tablet, then release within 0.5S, the switch status changes (ON / OFF). When the human touch the touch tablet over 0.5 S, the switch will turn to adjustment status (high - low - high).

Specifications:

Working Voltage	DC12V/24V
Maximum Load	DC12V/36W DC24V/72W
Quiescent Current	0.3mA
Working Temperature	-20 — +45°C
Adjustment Method	Voltage Control

Installation Instructions:

As shown

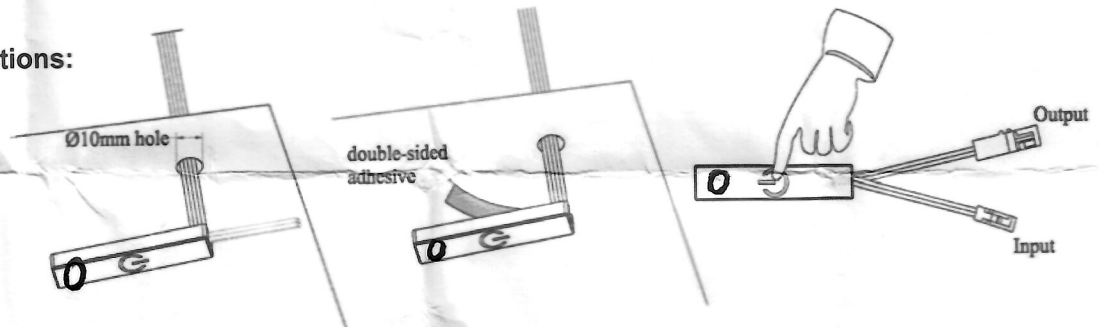

0-CTT LED DIMMER CONTROLLER