

product & accessory

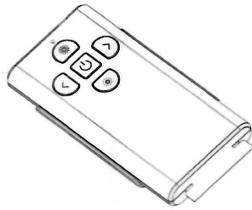

1* wireless emitter of remote control switch & dimmer & CCT

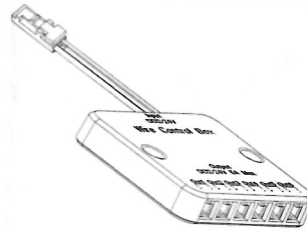

1* CCT wireless receiver



2*screw

A1

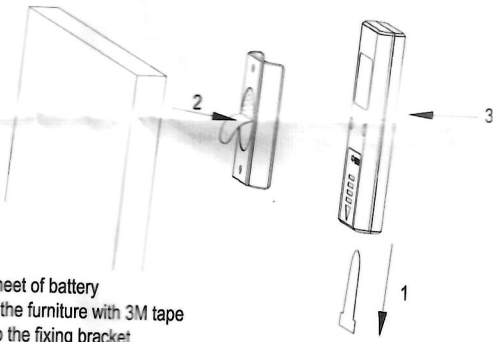

1. take off insulation sheet of battery
2. Fix the bracket onto the furniture with 3M tape
3. Clip the emitter onto the fixing bracket

A2

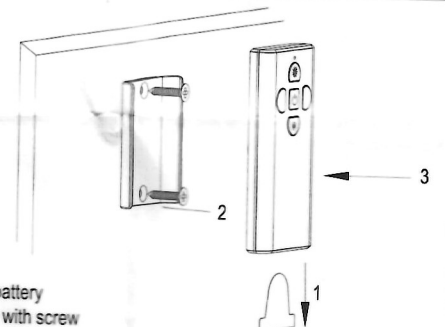

1. take off insulation sheet of cell battery
2. Fix the bracket onto the furniture with screw
3. Clip the emitter onto the fixing bracket

CCT wireless receiver

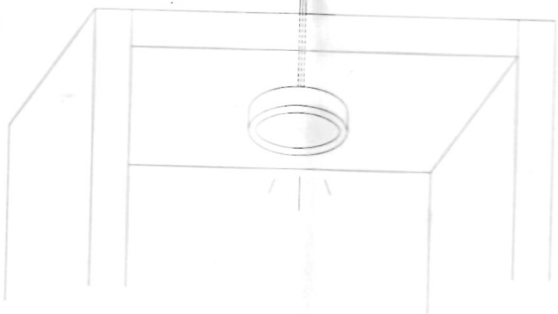
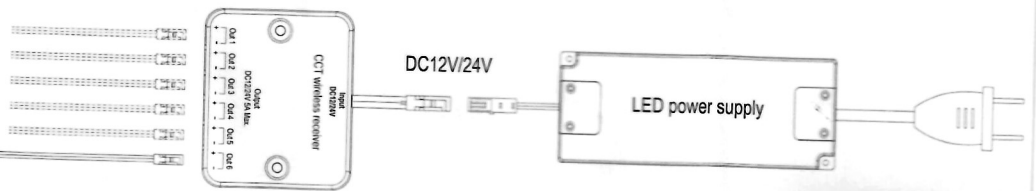

wireless control distance 10M

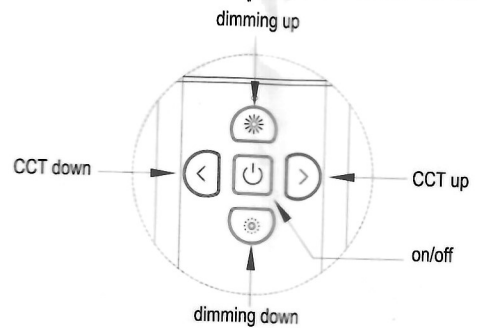

stepless dimming & CCT change:
 left button: CCT down to warmest
 right button: CCT up to coldest
 up button: dimming up to 100% brightness
 down button: dimming down to 10% brightness
 middle button: on/off

pairing/unpairing

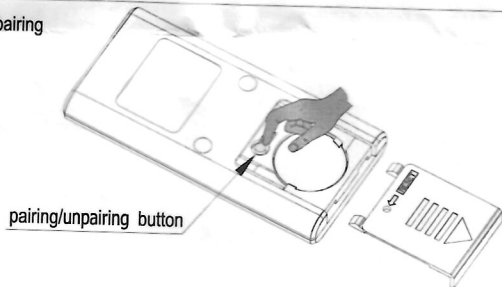

1. Pairing: Press the pairing button on the emitter within 3seconds after receiver connected to the power supply, it's successfully paired when the output light flash .
2. Unpairing: Long press (over 3S) the pairing button on the emitter within 3seconds after receiver connected to the power supply, it's successfully unpaired when the output light flash .
3. One receiver can be paired with multiple emitters, one emitter can be paired with max. eight receivers. (one receiver and one emitter already paired in production, pls do the multiple pairing and unpairing by yourself.)

Battery change

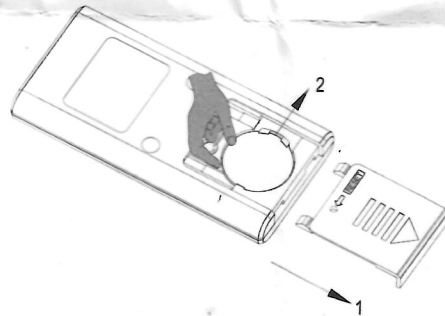

Indicating light quickly flashes when battery is low

1. Pull out the battery box
2. Change a new CR2032 cell battery